

0m 250m



NOTES / REVISIONS

KEYS:

Application Boundary

Site Boundary in Applicant's Control

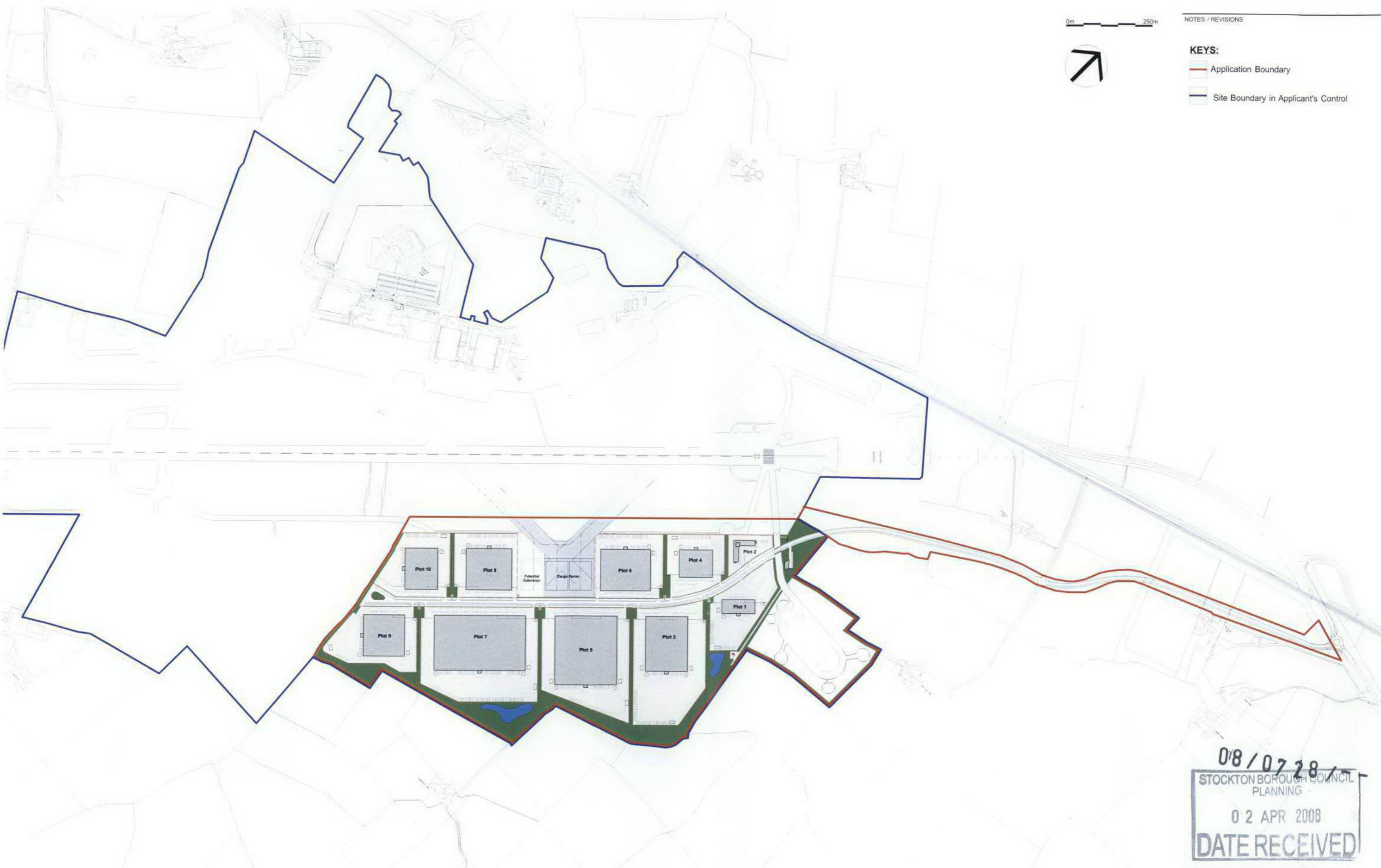

08/0728/15
 STOCKTON BOROUGH COUNCIL
 PLANNING
 02 APR 2008
 DATE RECEIVED



Skylink International Business Park, Durham Tees Valley Airport



JOB TITLE: Skylink International Business Park
 DRAWING TITLE: Proposed Site Plan
 SCALE: 1:5000@A1
 DRWN: SK CHD: DAC REVD: 31/03/08
 JOB NO. DWG NO. **S1596 / PO-02**